

Technical Data sheet

Coaxial Connector
7/16"-(f) EZ-Connector - Crimp/Solderless

03.03.088

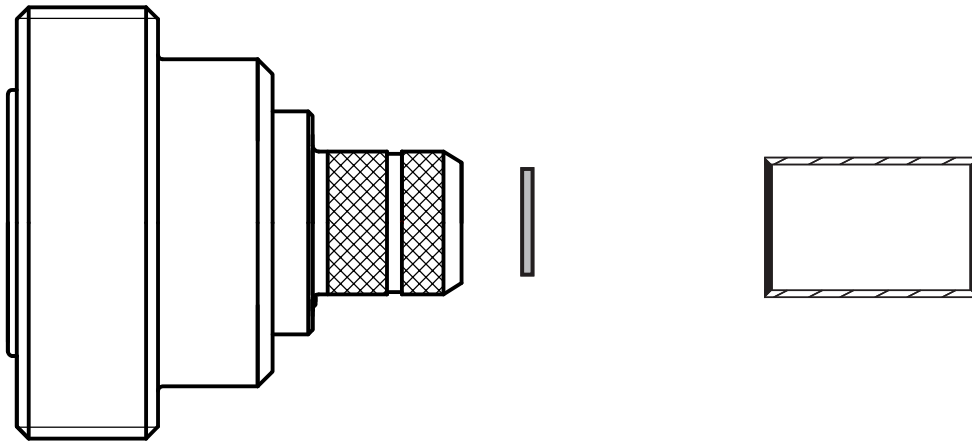

Site 1: 7/16"-female
Cable Types: FF400, LMR400, H2000, HF400, CNT400

Electrical characteristics

Impedance	50 Ω
Frequency Range	DC - 7.5 GHz
VSWR	≤ 1.2 (0-3 GHz)
Intermodulation (PIM)	≤ -140 dBc (2x43dBm)
RF Leakage @ 1GHz	≥ 128 dB
Dielectric withstanding voltage (at sea level)	3000V
Working Voltage (at sea level)	2700V
Insulation resistance	≥ 5000 M Ω

Mechanical characteristics

Coupling nut torque (recommended)	25 Nm
Coupling nut retention force	200 N
Durability (matings)	≥ 500
Temperature range	-55°C to +155°C

Type	Material	Plating
Center Conductor	Brass	Gold
Insulation	PTFE	-
Body	Brass	Ternary-Alloy (CuZnSn)
Gaskets	Silicone	-

ASSEMBLY INSTRUCTION

Coaxial Connector
7/16"-(f) EZ-Connector - Crimp/Solderless

03.03.087

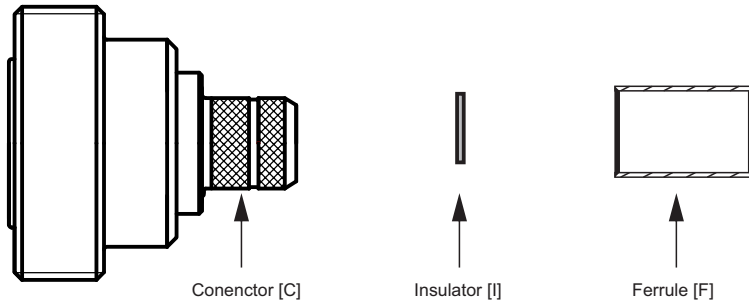

STEP 1

- Slide the ferrule over cable
- Strip as shown

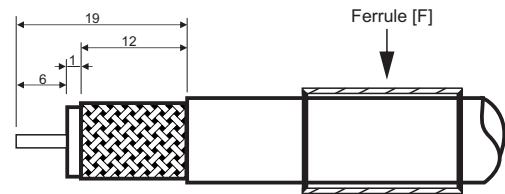

ALL DIMENSIONS IN MILLIMETERS

STEP 1

- Inner conductor needs to be absolutely straight and free of fin
- Slide the Insulator onto the inner conductor

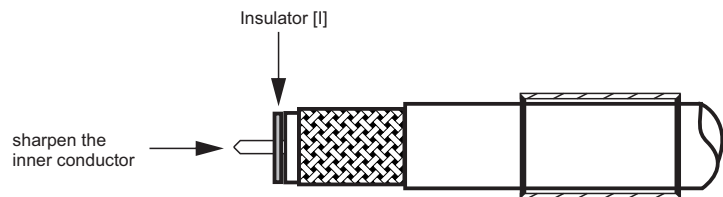

STEP 1

- Flare out braid away from foil back to the jacket
- Slide the Connector onto the cable between foil and braid

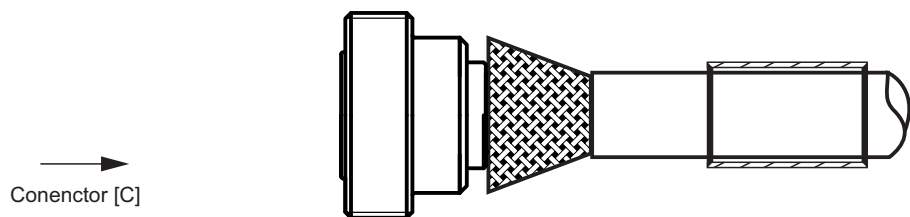

STEP 1

- Slide the ferrule over cable
- Crimp with 10.9mm HEX

